

INSTRUCTION MANUAL

MGT-1T Mobile Girder Rail 1 Tonne



C188

WLL 1000 KG MOBILE GIRDER RAIL

Extra Customer instructions to be used in conjunction with Factory assembly drawing

Please follow positioning and orientation of parts as per factory Assembly drawing supplied, using details below as reference.

When putting nuts and bolts together on Lifting equipment, it is a good practice to put bolt up from underneath and nut on top.

This way if nut comes loose, bolt falls out and it will be noticed missing .

If put with bolt from top and the nut falls off, the bolt stays were it is and is not noticed as a problem as readily.

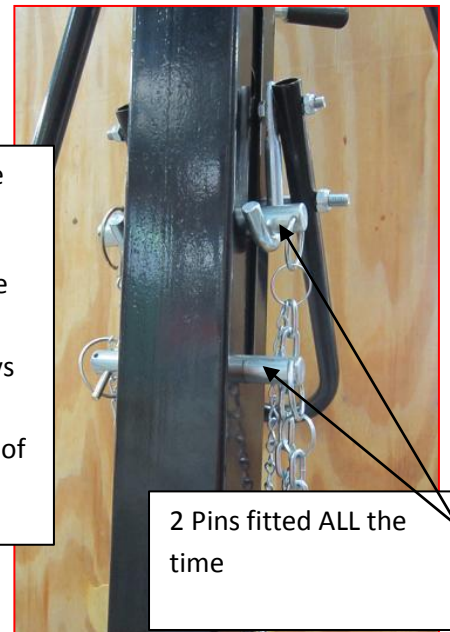

Note position of lifting hooks assembled on inside edges of "U" lifting lever

N.B. Only ONE Lifting/Safety Pin is shown in these pictures for instruction picture clarity...Two Pins Must always be left in, and Lynch Pins must always be fitted when not adjusting height of trolley.

Never use only one PIN to try and exceed limits of use.

2 Pins fitted ALL the time



Lynch Pin fitted correctly

1T CRANE

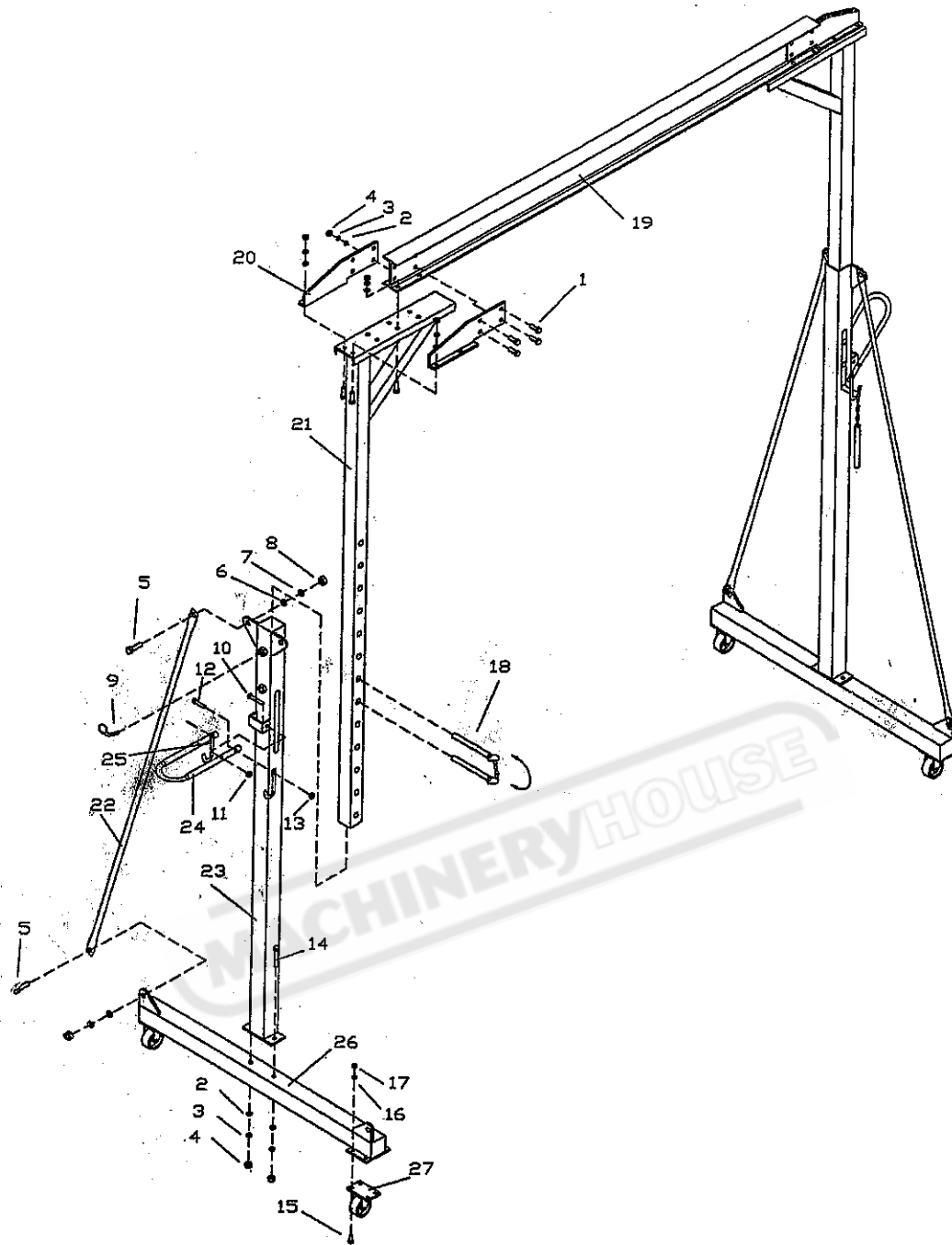

PART	DESCRIPTION	QTY	PART	DESCRIPTION	QTY
1	Bolt M12X35	24	14	Bolt M12X100	4
2	ø12 washer	28	15	Bolt M10X30	16
3	ø12 spring washer	28	16	ø10 spring washer	16
4	M12 nut	28	17	M10 nut	16
5	Bolt M14X40	8	18	Pin	4
6	ø14 washer	8	19	Crossbeam	1
7	ø14 spring washer	8	20	Plate	4
8	M14 nut	8	21	Inner Vertical Post	2
9	M12 Bolt	4	22	Support Tube	4
10	Bolt M10X60	4	23	Outer Vertical Post	2
11	M10 nut	4	24	Handle	2
12	Bolt M8X40	4	25	Pin	4
13	M8 nut	4	26	Base assembly	2
			27	Wheel	4